

# S12

## Socket for Interface relay

<b>Type</b>	<b>S12</b> I/O socket for C12 relays with 2 x CO Logic connection , 5 A
<b>Rated current</b>	<b>5 A</b>
<b>Specifications</b>	
Rated load	5 A / 250 V
Insulation	Test voltage V rms / 1 min
- All terminals/DIN rail	5 kV
Contacts terminals	2,5 kV
Contacts / Coil terminals	5 kV
Cross-section of connecting wire	
- Single-wire	4 mm <sup>2</sup> or 2 x 2,5 mm <sup>2</sup>
- Multi-wire	22 - 14 AWG
Max. screw torque	1,2 Nm
Screw dimensions	M3, Pozi, slot
Integrated retaining clip/plastic	for relay series C12
Labelling space	detachable
Connection label	1...9; DIN/EN
Mounting	DIN rail TS35 or mounting plate
Ambient temperature operation/storage	-40 (no ice)...60 °C / -40 ... 80 °C

**Socket for IRC relays** = **C12, C12G**

**Accessories**

Coil bridge bars

- V10-G, V40-G**
- V10-R, V40-R**
- V10-A, V40-A**
- B20-G, B20-R**
- B20-A**

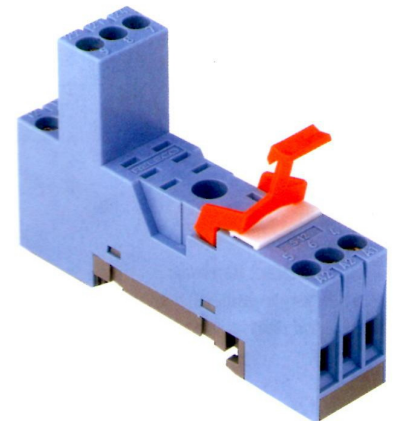

**Connection diagram**

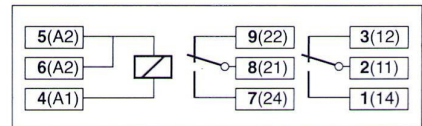

**Dimensions [mm]**

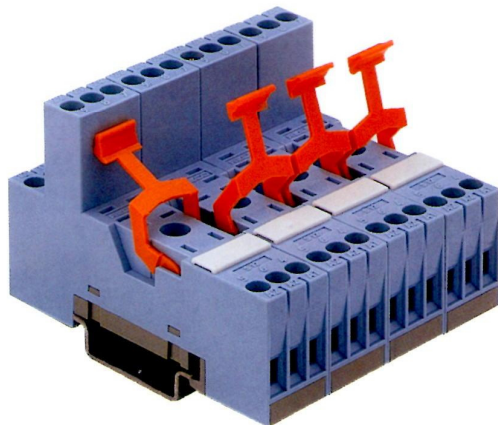
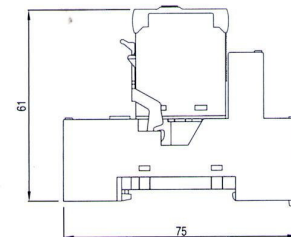
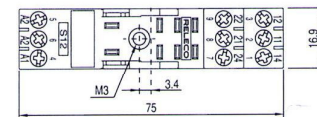
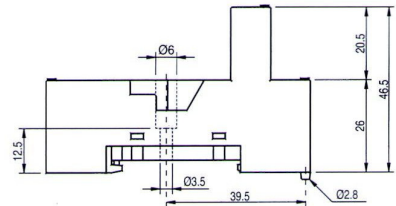

Sockets

4

**Technical approvals, conformities**



IEC 61810 EN 60947