

# S12-P

## Printed circuit socket for Interface relays, C12

**Type:** **S12-P**  
 Printed circuit socket for 2-pole C12 relay

**Rated current** **5 A**

**Specifications**

Rated load	5 A / 250 V
Insulation	Test voltage V rms / 1 min
- Pole / Pole	3 kV
- Coil / contact terminals	5 kV
Hard brass tin-plated terminals	0,5 x 1 mm
Integrated hold-down clip	



**Dimensions [mm]**

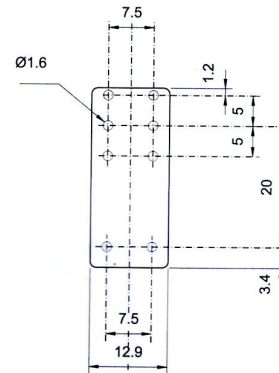
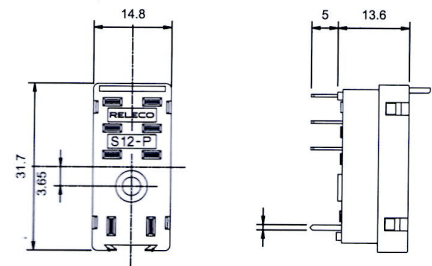

**Technical approvals, conformities**



IEC 61810 EN 60947