

S2-B

Socket for 8-pin standard relay according to IEC 67-I-5B



Type **S2-B**
 2-pole, 1 connection level
 Coding ring optional
 Integrated retaining clip and labelling space

Rated current **10 A**

Specifications
 Rated load 10 A / 300 V
 Insulation Test voltage V rms / 1 min
 – All terminals/DIN rail 2,5 kV
 – Terminal/terminal 2,5 kV
 Cross-section of connecting wire
 – Single-wire 4 mm² or 2 x 2,5 mm²
 – Multi-wire 22 - 14 AWG
 Max. screw torque 1,2 Nm
 Screw dimensions M3, Pozi, slot
 Integrated retaining clip/plastic for relay series C2
 Labelling space detachable
 Connection label 1...8; DIN/EN
 Mounting DIN rail TS35 or mounting plate
 Ambient temperature operation/storage -40 (no ice)...60 °C / -40 ... 80 °C

Associated, plug-in 8-pin MRC relays **C2-A, C2-G, C2-T**
 Suitable for holding the Releco coding ring
 For coding the relay and the socket.

Accessories
 Coding ring, blue set: **S2-BC**
 Packaging unit: 5 pcs
 Retaining spring, steel **S3-C, S3-CT** (with Timecube)



Connection diagram

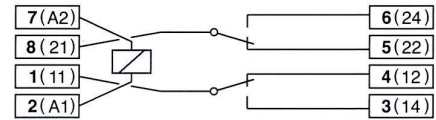

Dimensions [mm]

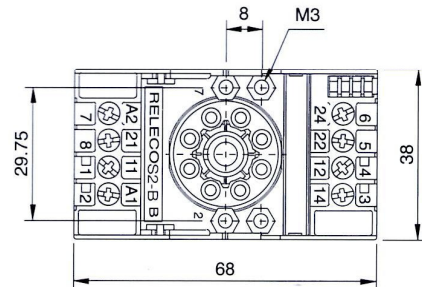
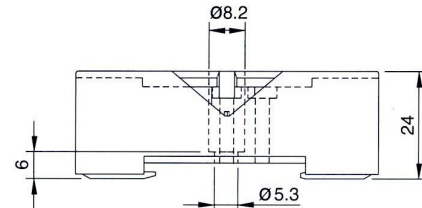

Technical approvals, conformities



EN 60947-1, EN 61810-1