

<b>Type</b>	<b>S4-J</b> 4-pole, 2 connection level Logic wiring Integrated retaining clip and labelling space
<b>Rated current</b>	<b>10 A</b>
<b>Specifications</b>	
Rated load	10 A / 250 V
Insulation	Test voltage V rms / 1 min
– All terminals/DIN rail	2,5 kV
– Terminal/terminal	2,5 kV
Cross-section of connecting wire	
– Single-wire	4 mm <sup>2</sup> or 2 x 2,5 mm <sup>2</sup>
– Multi-wire	22 - 14 AWG
Max. screw torque	1,2 Nm
Screw dimensions	M3,5, Philips-slot (combo)
Integrated retaining clip/plastic	for relay series C4
Labelling space	detachable
Connection label	1...14; DIN/EN
Mounting	DIN rail TS35 or mounting plate
Ambient temperature	-40 (no ice)...60 °C / -40 ... 80 °C
<b>Associated, plug-in 11-pin MRC relays</b>	<b>C4-A, C4-X, C4-R</b>
<b>Accessories</b>	
Retaining spring, steel	<b>S4-C</b>

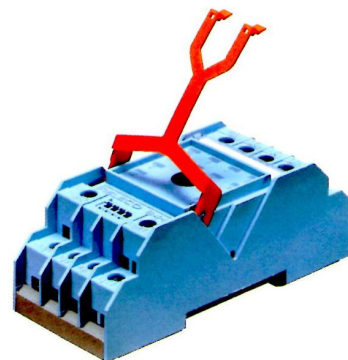

### Connection diagram

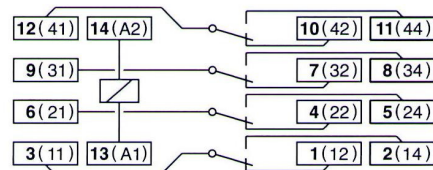

### Dimensions [mm]

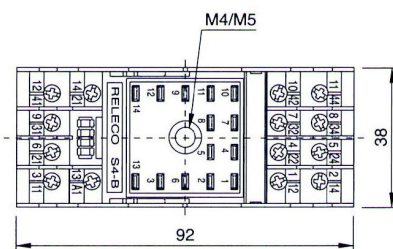
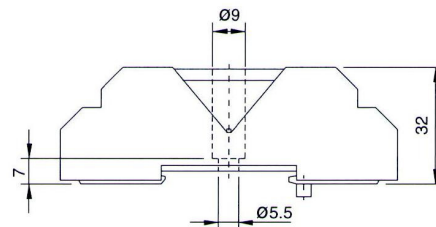

Sockets

4

### Technical approvals, conformities



EN 60947, EN 61810