

S3-MP**Socket for 11-pin standard relay according to IEC 67-I-18b****Type****S3-MP**

3-pole, 1 connection level
 Integrated retaining clip and labelling space
 Accepts plug-in modules M3P in parallel with the coil

Rated current**10 A****Specifications**

Rated load	10 A / 250 V
Insulation	Test voltage V rms / 1 min
– All terminals/DIN rail	2,5 kV
– Terminal/terminal	2,5 kV
Cross-section of connecting wire	
– Single-wire	4 mm ² or 2 x 2,5 mm ²
– Multi-wire	22 - 14 AWG
Max. screw torque	1,2 Nm
Screw dimensions	M3, Pozzi, slot
Integrated retaining clip/plastic	for relay series C3
Labelling space	detachable
Connection label	1...11; DIN/EN
Mounting	DIN rail TS35 or mounting plate
Ambient temperature operation/storage	-40 (no ice)...60 °C / -40 ... 80 °C

Associated, plug-in 11-pin MRC relays

Suitable for holding the Releco coding ring
 For coding the relay and the socket.

**C3-A, C3-G, C3-T, C3-X, C3-M, C3-R,
 C3-E, C3-N, C3-S**

Accessories

Coding ring, blue set:

Paralel module

Retaining spring, steel

S3-BC

Packaging unit: 5 pcs

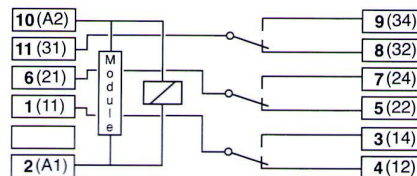
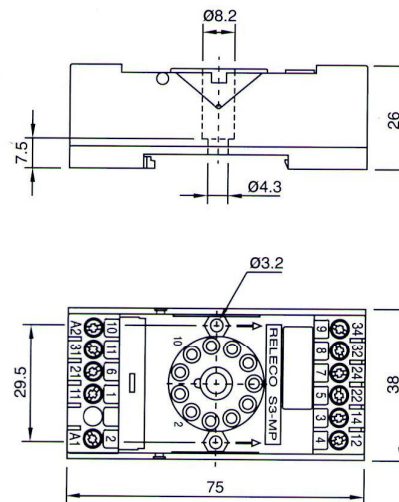
M3P**S3-C, S3-CT** (with Timecube)**Connection diagram****Dimensions [mm]****M3P** Plug in modules for S3-MP

In parallel with the coil



Signaling LED

M3P-X / 24 Vac/dc
 M3P-X / 48 Vac/dc
 M3P-X / 110 ... 125 Vac/dc
 M3P-X / 200 ... 230 Vac/dc

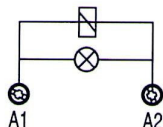

Free wheeling diode and LED

M3P-DX / 24 Vdc
 M3P-DX / 48 Vdc
 M3P-DX / 110 ... 125 Vdc
 M3P-DX / 200 ... 230 Vdc

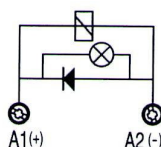

Free wheeling diode

M3P-DL / 12 ... 60 Vdc
 M3P-DH / 12 ... 250 Vdc

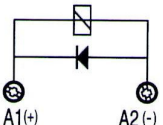
RC suppressor
(LED not available)

M3P-RC / 20 ... 50 Vac
 M3P-RC / 110 ... 120 Vac
 M3P-RC / 220 ... 240 Vac

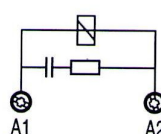
**Technical approvals, conformities**

EN 60947-1, EN 61810-1